



### **You Have a Need**

If you need a space for your corporate meetings; a place central to all the cities in the Triangle that includes everything from high-speed internet access and business services to Starbucks™ coffee and full-service catering, then...

### **We Have the Solution**

The Solution Center offers 20,000 square feet of meeting space, with rooms that accommodate as many as 150 people or as few as one. However, we have much more than space to offer.

Our professional environment offers audio-visual equipment, wireless internet access, ergonomic workspace, courtesy rooms for one person to get away from the fray, and a knowledgeable, helpful staff at your service. In short, walk out of your office straight into ours and you won't miss a step.

Along with the small details, like the freshly baked Otis Spunkmeyer™ cookies you'll have during breaks, we'll be sure the important considerations are covered. You can count on our technical expertise and our onsite concierge to help make your meeting a success.

When the work day is over, you can retire to any one of the nearby hotels, using the free shuttle service, and get our preferred Solution Center sleeping room rates.

Our satisfied and ongoing clients include Cisco Systems, GlaxoSmithKline and IBM.

### **Call Us Today**

Come in for a tour and to find answers to any questions you may have. Call Amy Heiskell at (800) 238-2426 or (919) 941-7713 to check availability. You may also send an email to [contact\\_us@TheSolutionCenter.com](mailto:contact_us@TheSolutionCenter.com).

***[www.TheSolutionCenter.com](http://www.TheSolutionCenter.com)***

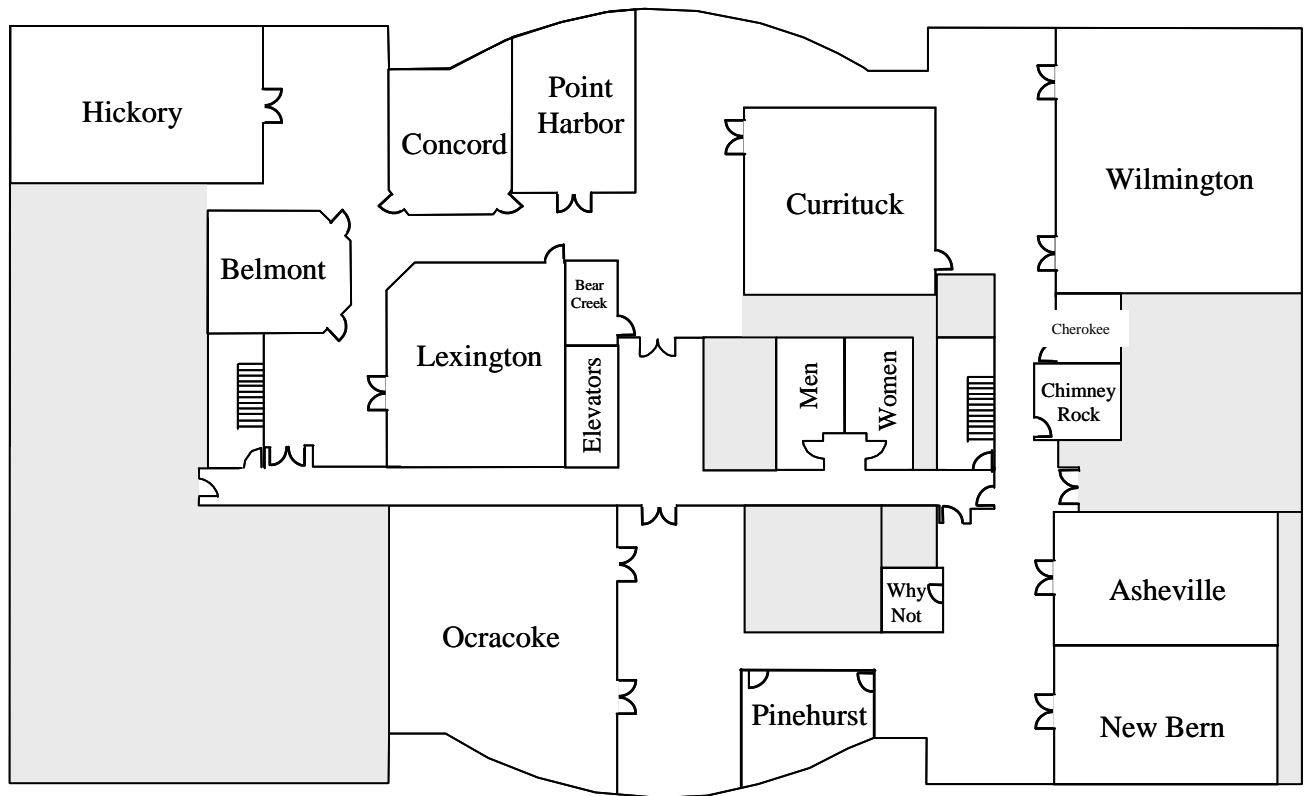

Room	Dimension	Sq. Feet	Board-room	Class-room	Rounds	Theater	U Shape
Asheville	21' x 39'	819	25	36	36	50	25
Bear Creek	8' x 12'	96	4	**	**	**	**
Belmont	20' x 23'	460	16	15	14	24	16
Cherokee	10' x 10'	100	4	**	4	**	**
Chimney Rock	12' x 14'	168	6	**	6	**	**
Concord	20' x 23'	460	16	15	14	24	16
Currituck	30' x 31'	930	26	36	42	75	26
Hickory	25' x 40'	1000	32	45	42	81	31
Lexington	29' x 33'	957	26	42	42	75	27
New Bern	21' x 39'	819	25	36	36	50	25
Ocracoke	40' x 40'	1600	30	84	84	120	35
Pinehurst	17' x 21'	357	10	10	12	15	10
Point Harbor	20' x 25'	500	18	16	18	27	16
Why Not	10' x 10'	100	4	**	4	**	**
Wilmington	40' x 45'	1800	32	91	91	150	40

## Common Room Layouts

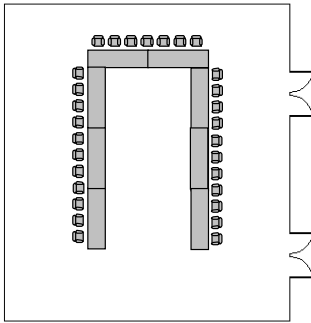

**U**

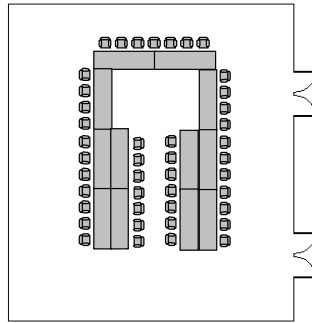

**Block**

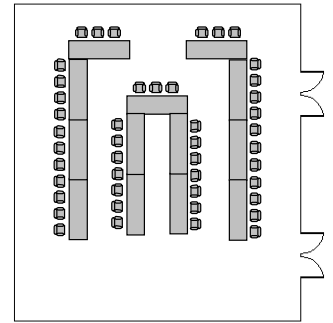

**Double**

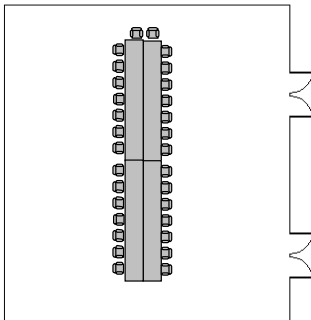

**Boat**

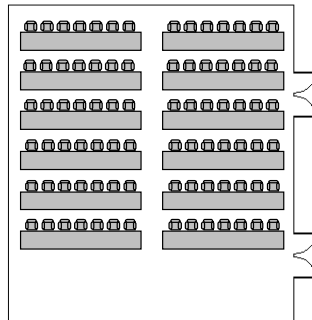

**Classroom**

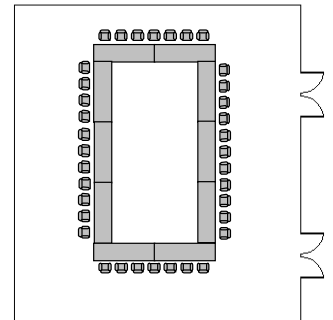

**Hollow  
Square**

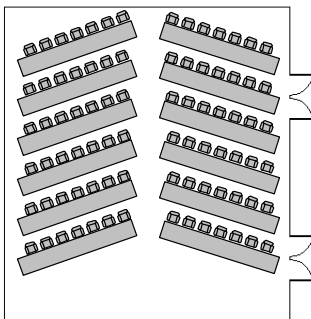

**Chevron**

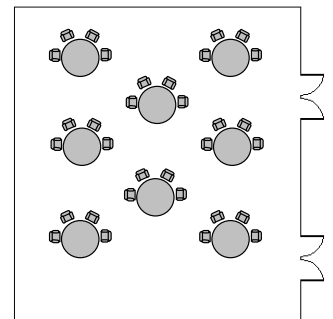

**Round**

**These are the most popular layouts. We are happy to create customized layouts to meet your needs.**



### Meeting Room Rates

<u>ROOM</u>	<u>WHOLE DAY</u>	<u>HALF DAY</u>
Asheville	\$550.00	\$450.00
Bear Creek	\$250.00	\$200.00
Belmont	\$400.00	\$300.00
Cherokee	\$250.00	\$200.00
Chimney Rock	\$250.00	\$200.00
Concord	\$400.00	\$300.00
Currituck	\$600.00	\$500.00
Hickory	\$600.00	\$500.00
Lexington	\$600.00	\$500.00
New Bern	\$550.00	\$450.00
Ocracoke	\$695.00	\$595.00
Pinehurst	\$300.00	\$250.00
Point Harbor	\$400.00	\$300.00
Why Not	\$250.00	\$200.00
Wilmington	\$695.00	\$595.00

Prices are subject to change without notice.



## Audio Visual Equipment

XGA Computer Projector	\$150.00
Wireless Remote Mouse	\$35.00
46" LCD Monitor	\$350.00
Laptop Computer	\$155.00
Laser Printer	\$100.00
Overhead Projector	\$45.00
Screen (6' or 8')	\$45.00
Post-it Flipchart pad, easel, markers	\$50.00
Easel	\$25.00
Whiteboard	\$45.00
Podium	\$55.00
TV/VCR or TV/DVD	\$150.00
VCR	\$75.00
DVD Player	\$75.00
Phone (long distance charges are extra)	\$100.00
Medium Conference Phone (15 people)	\$135.00
Large Conference Phone (15 + people)	\$165.00
Laser Pointer	\$25.00
CD/Cassette Player	\$50.00
Wireless Microphone with Sound System	\$200.00
Wired Microphone with Sound System	\$180.00
Additional Wireless Microphone	\$100.00
Additional Wired Microphone	\$80.00
Direct Box	\$45.00
(connects projector to sound system)	
Modem Line	\$100.00
Power Strip (1 <sup>st</sup> one is free)	\$5.00

### Internet Access

The Solution Center has free wireless access. If you need dedicated wireless (where the entire group will be using the wireless at one time) or wired connections, please use pricing below.

### Dedicated Wired or Wireless Internet Connections

\$150 for first user + \$20 for each additional user up to a maximum of \$500 per day

All prices subject to 7.75% NC sales tax.  
Prices are subject to change without notice.



### **Business Services/Supplies**

<b>Black &amp; White Copies (first 25 are free)</b>	<b>\$.20 each</b>
<b>Color Copies</b>	<b>\$1.00 each</b>
<b>Faxes (per page)</b>	<b>\$1.50 local/\$2.00 long distance</b>
<b>Sticky Name Badges</b>	<b>\$.75 each</b>
<b>Pad &amp; Pen</b>	<b>\$2.00</b>

**All prices subject to 7.75% NC sales tax.  
Prices are subject to change without notice.**



## Specialty Break Packages

Never underestimate the importance of food to your meeting's success. The Solution Center's refreshments, meals, selection and service consistently receive high praise.

### The Crossroads Café

Simply request The Crossroads Café Break Package, and all day long your guests will have unlimited access to beverages, breakfast and break food. Our café offers a wide selection of fresh, delicious food to suit a variety of tastes and dietary needs. Located in the main lobby of The Solution Center, The Crossroads Café is the perfect place for your guests to enjoy their breaks or to pick up snacks to take back to their conference room.

### The Crossroads Café Break Package includes a variety of:

Krispy Kreme doughnuts, bagels & muffins, yogurts, whole fruit, cheeses, vegetables & dip, freshly baked cookies, protein and low carb bars, candy bars, chips & pretzels, nuts, ice cream bars and unlimited beverage service

### Unlimited Beverage Service for All Guests

The Solution Center wants your guests to be productive and satisfied. All lobby areas outside our conference rooms have Starbucks coffee, specialty teas and hot chocolate, as well as refrigerators filled with assorted soft drinks, juices and bottled water.

### For All Day Meetings (choose 1)

- The Crossroads Café All Day Break & Beverage Package \$19.50 per person (includes unlimited continental breakfast, breaks & beverages)
- All Day Beverage Service \$13.50 per person (minimum for all groups)

### For Half Day Meetings (choose 1)

- The Crossroads Café Half Day Break & Beverage Package \$13.95 per person
- Half Day Beverage Service \$8.50 per person (minimum for all groups)

*Our Unlimited Beverage Service is a minimum requirement for all groups meeting at The Solution Center.*

*Please note that lunch and dinner are not included in The Crossroads Café Break Package. See our separate lunch and dinner menu.*

*All prices subject to 18% service charge and 7.75% NC sales tax.*

**Prices are subject to change without notice.**



## Directions

### From (Raleigh, Cary, Morrisville) I-40 Westbound:

Take Exit 282 (Page Road) to end of the ramp and make a right onto Page Road. Go to 2nd traffic light and take a left onto Slater Road. We are the 2nd building on the right, Brighton Hall, 1101 Slater Road. Please come to the second floor.

### From (Durham, Chapel Hill) I-40 Eastbound:

Take Exit 282 (Page Road) to end of the ramp and make a right onto Page Road. Go to 1st traffic light and take a left onto Slater Road. We are the 2nd building on the right, Brighton Hall, 1101 Slater Road. Please come to the second floor.

Chapel  
Hill  
Durham

**The Solution Center**  
Brighton Hall, Suite 200  
1101 Slater Road  
Durham, NC 27703  
919-941-7713

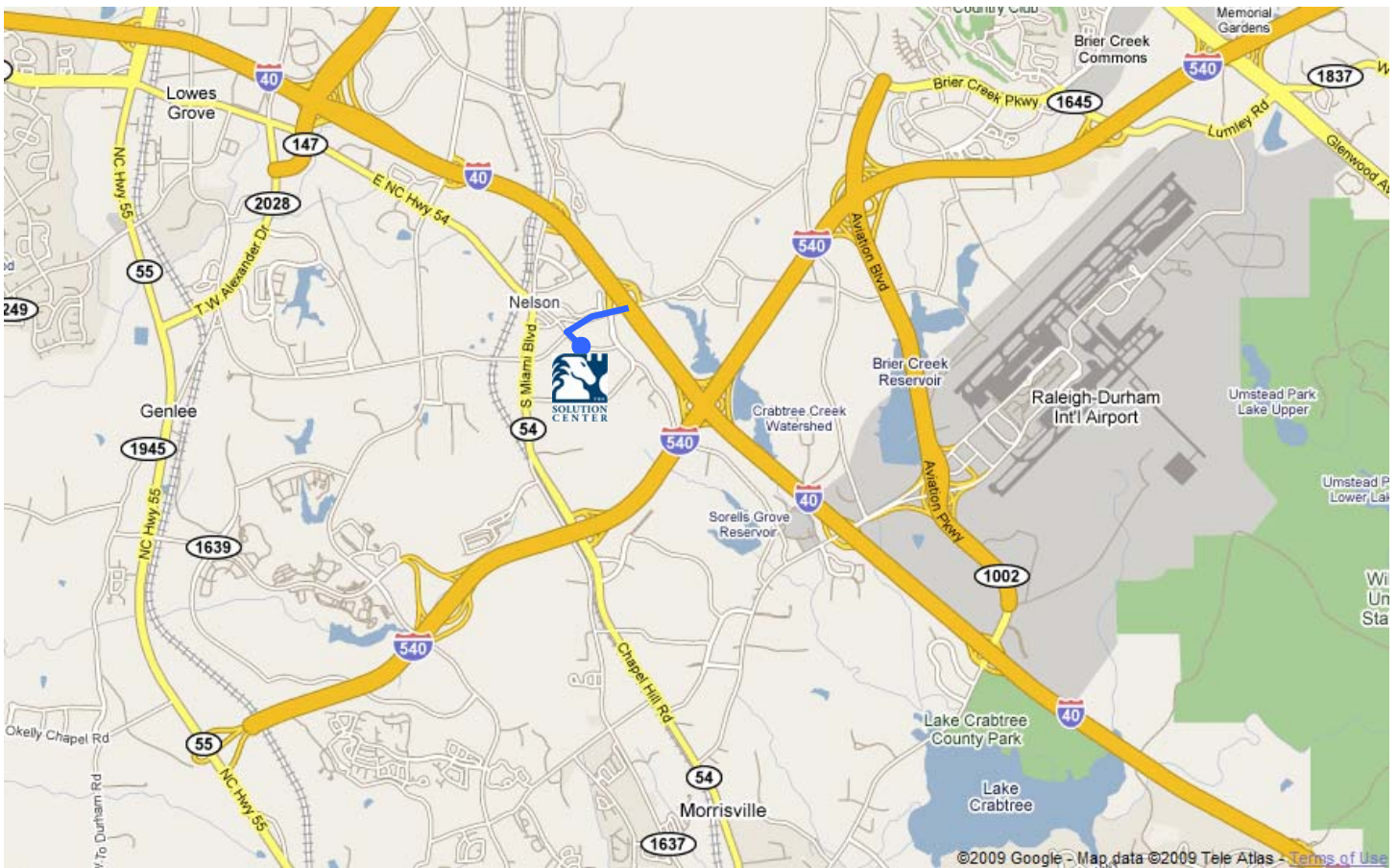

©2009 Google - Map data ©2009 Tele Atlas - Terms of Use